

NOVA

180° Wrap Edge

- Sleek styling of a 180° postformed edge.
- Perfect for customers looking for a rounder profile.



TEXAS

SPECIFICATIONS

- Standard substrate is 3/4" industrial grade particleboard, available in 8', 10' and 12' lengths. Other substrates and backers available upon request.
- Standard postformed grade laminate with a thickness of 0.039" ± 0.005".
- Both standard and special styles and sizes are suitable for all residential, commercial, institutional or light industrial applications.
- Available surfaced with Wilsonart®, Formica®, Nevamar® and Pionite®.

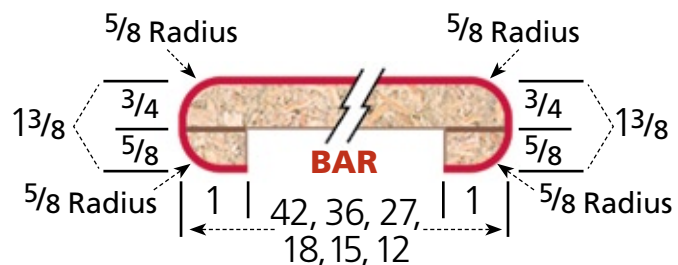
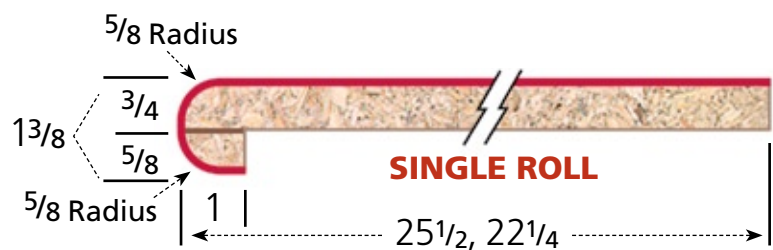
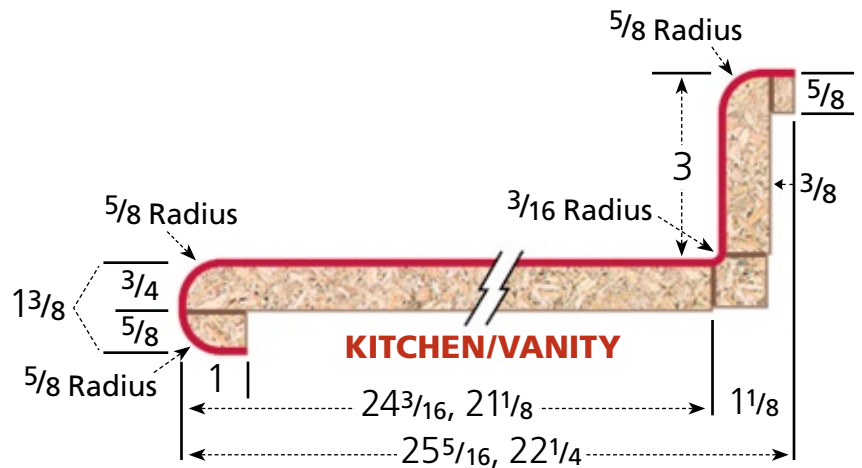

All measurements in inches.
Drawings not to scale.

Printed on recycled and recyclable paper.

BJS NO-TX 0606

CUSTOMER SERVICE

P 888.287.8356

F 712.368.4188

WWW.VTINDUSTRIES.COM/COUNTERTOPS

VT Fine Laminate
INDUSTRIES Countertops